



IT'S MUCH LESS EXPENSIVE TO DO THINGS RIGHT THAN IT IS TO DO THINGS OVER.



WATCO



Always a step ahead 

Watco 901 Innovator® Half Kit

The Watco best-selling workhorse. Self-aligning, no leaks.

- Extends into tub through overflow; tightens securely with retainer nut
- Overflow ell is self-centering, self-aligning and won't slip
- Eliminates costly behind-tub leaks
- Includes drain test plug and overflow test membrane; testable up to five floors (22 psi)
- No tools required
- Available in PVC and ABS

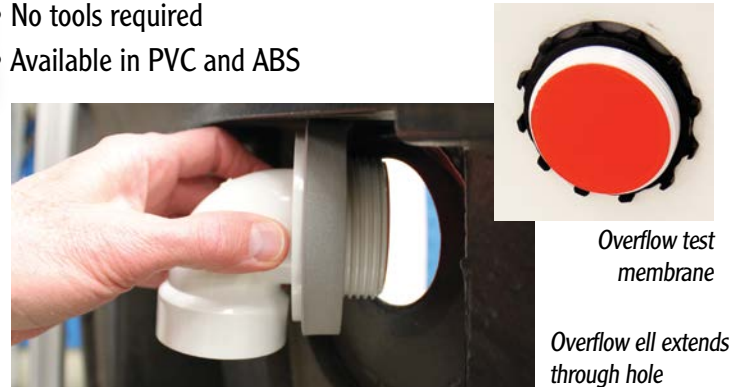

Watco QuickTrim®

The simplest, easiest way to change finishes.

- Rough-in with our 901 RI, finish in one of 12 QuickTrim® designer finishes when you're ready
- Avoid damaging drain finish during construction
- Upgrade to special finish in minutes
- No need to remove bathtub strainer body
 - Fits most bathtub drains



Rough-in with chrome...



...drop in designer finish and stopper when construction is finished.

Watco Flex924

- Flexible tubing bends to compensate for misalignment, eliminating offsets and potential leaks
- Tubing can be cut and fit using standard PVC joining techniques
- Includes Innovator® overflow system—self-centering overflow ell extends through overflow hole, eliminating leaks
- Snap-on, easy-clean Innovator® overflow faceplate provides alternative to one- or two-hole overflow faceplates
- Saves time and money—lowest installed cost
- Approvals include UPC, IAPMO, IPC, ASME, CSA

Bye-bye offsets.



Innovator® Shower Drain

Receptor-type drain for pre-formed shower bases

- Includes Watco Innovator® orange test membrane, testable to 22 P.S.I. or five floors. No more test balls, caps or plugs.

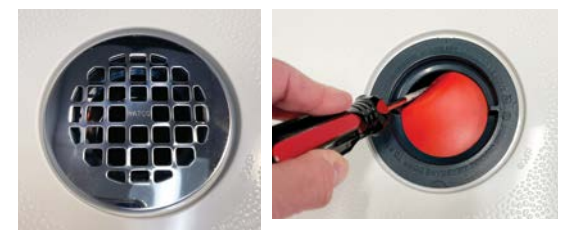

- Top piece is dark grey PVC to reduce appearance of dirt and mildew. Bottom piece available in white PVC or black ABS.



Patent Pending

- Includes heavy-duty, snap-on grid—20% thicker than competitive grids.



MULTI-FAMILY PRODUCTS

Watco 901N Innovator[®] Drain



Designer white for less than chrome.

- One person can install in minutes
- Integrated strainer body/drain elbow eliminates one solvent weld joint; fewer joints = fewer problems
- One-piece strainer body/drain elbow installs through tub drain hole; locking nut will not loosen
- Overflow and drain come with test membranes, testable up to five floors (22 psi)
- Standard high-gloss white matches tub
- Easy to change finish with Watco QuickTrim[®]
- Available in PVC and white ABS

Installs in four easy steps



WatcoFlex[®]

Installs in minutes!



- Designed for high-volume, multi-family projects
- Specifically sized to the tub
- No measuring, cutting or gluing
- Joints are leakproof; factory welded and tested
- Testable up to five floors (22 psi)
- Available in PVC and ABS
- Approvals include UPC, IAPMO, IPC, ASME, CSA



816.796.3900 ■ watcomfg.com